

CCASF633-0000410F0

Neo Modern

Neo Modern vessel

#### STYLE SEGMENT

- Modern

#### KEY SPECIFICATIONS

- Installation Type: Vessel
- Product Dimensions: 545 x 400 x 166
- Material: Fine Fire Clay
- Color: White Heat II
- Overflow Hole: Without
- Faucet Ledge: No
- Included Components: Drainage & cover



#### SHIPPING WEIGHT

- Net Weight: 10
- Gross Weight: 12

#### KEY TECHNOLOGIES AND FEATURES

##### HYGIENE

- Complies with American Standard Quality Standards

##### COMFORT

- Complies with American Standard Quality Standards

##### CONVENIENCE

- Complies with American Standard Quality Standards

##### DURABILITY

- Complies with American Standard Quality Standards

##### SUSTAINABILITY

- Complies with American Standard Quality Standards

##### SAFETY

- Complies with American Standard Quality Standards

##### OTHERS

- NIL

#### STANDARDS AND CERTIFICATIONS

- GB/T 6952-2015

CCASF633-0000410F0

Neo Modern

Neo Modern vessel

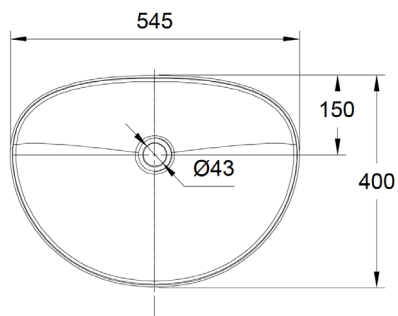
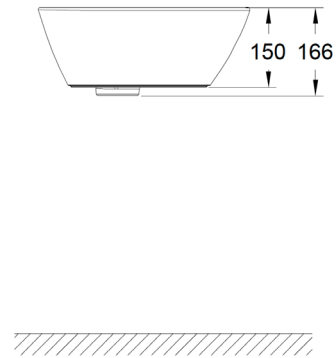
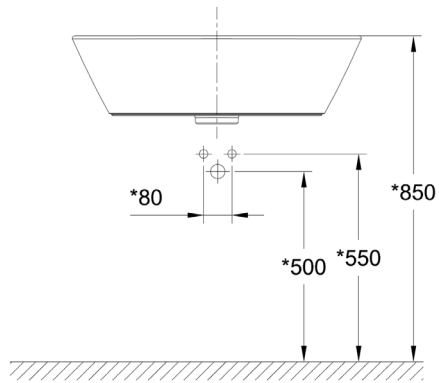

CCASF633-0000410F0

Neo Modern

Neo Modern vessel

<b>Item</b>	Description	Vessel
<b>Installations</b>	Type	Vessel
<b>Dimensions</b>	Product (mm)	545 x 400 x 166
<b>Material &amp; Color</b>	Material	Fine Fire Clay
	Color	White Heat II
<b>Features</b>	Overflow Hole	Without
	Faucet Ledge	No
<b>Components</b>	Included	Drainage & cover
<b>Shipping</b>	Net Weight (kg)	10
	Gross Weight (kg)	12
	Product Weight (kg)	10
	Dimensions (mm)	587 x 440 x 224