

CLO519I-6DACTLS

Acacia Evolution

Acacia E Semi Counter 50cm. Lava WT

STYLE SEGMENT

- Modern

KEY SPECIFICATIONS

- Installation Type: Semi-Counter
- Product Dimensions: 460 x 500 x 190
- Material: Vitreous China
- Color: White
- Overflow Hole: With
- Faucet Ledge: Yes
- Included Components: Overflow Plug, Brackets & Adjustable Hook, Installation Template



SHIPPING WEIGHT

- Net Weight: 19.44
- Gross Weight: 19.54

KEY TECHNOLOGIES AND FEATURES

HYGIENE

- Proguard

COMFORT

- Complies with American Standard Quality Standards

CONVENIENCE

- Complies with American Standard Quality Standards

DURABILITY

- Complies with American Standard Quality Standards

SUSTAINABILITY

- Complies with American Standard Quality Standards

SAFETY

- Complies with American Standard Quality Standards

OTHERS

- NIL

STANDARDS AND CERTIFICATIONS

- TIS-791:2554(2011)

CLO519I-6DACTLS

Acacia Evolution

Acacia E Semi Counter 50cm. Lava WT

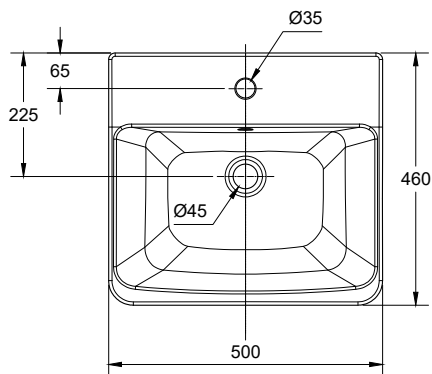
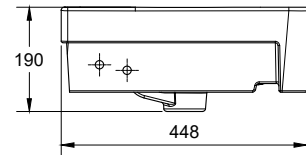
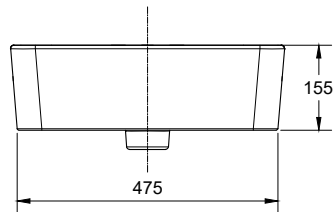

CL0519I-6DACTLS

Acacia Evolution

Acacia E Semi Counter 50cm. Lava WT

Item	Description	Acacia E Semi Counter 50 cm.
Installations	Type	Semi-Counter
Dimensions	Product (mm)	460 x 500 x 190
Material & Color	Material	Vitreous China
	Color	White
Features	Overflow Hole	With
	Faucet Ledge	Yes
Components	Included	Overflow Plug, Brackets & Adjustable Hook, Installation Template
Shipping	Net Weight (kg)	19.44
	Gross Weight (kg)	19.54
	Product Weight (kg)	16
	Dimensions (mm)	525 x 215 x 500